

## Ethafoam® 2222

*Acoustic Insulation Foam*



**Ethafoam® 2222 is a closed-cell polyethylene foam material designed for use as a resilient acoustic insulation layer in concrete floor structures.**

### Key benefits include:

- Superior impact sound insulation – conforms to European Building Standards.
- Minimal moisture retention – closed-cell structure allows use in humid environments.
- Lightweight – easy to install.
- Low profile installation – minimal increase in floor height.
- Ageing resistant – formulated to withstand degradation caused by alkaline in concrete floors.
- Highly resilient – withstands the rigours of an on-site environment.
- Versatile – can be installed as single or multiple layers dependent on space and performance requirement.

### Product Dimensions:

Thickness	5mm
Roll Length	75m
Roll Width	1.5m
Roll Diameter	0.75m
Surface Area of Roll	112.5 m <sup>2</sup>

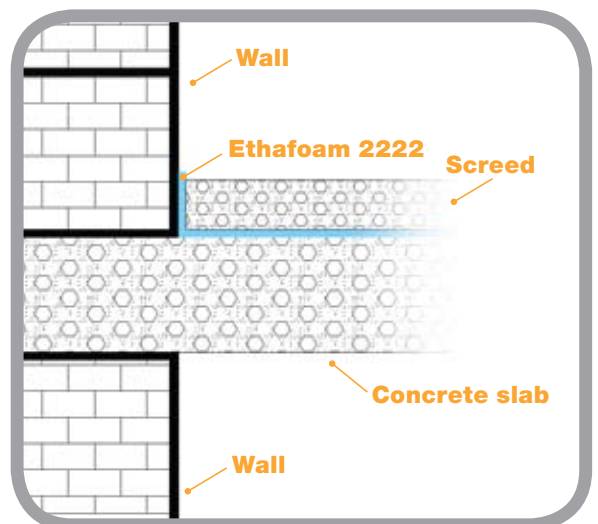

# Ethafoam® 2222

## Acoustic Insulation Foam

PHYSICAL PROPERTIES	TEST METHOD	UNITS	VALUE
Thickness	EN12431	mm	5
Compressive strength 25% Compression 50% Compression	DIN 53577	kN/m <sup>2</sup>	23 77
Density	ISO 845	Kg/m <sup>3</sup>	33
Impact sound insulation	EN ISO 140-7 EN ISO 140-8	L'nT,w (dB) $\Delta L_w$ (dB)	52 20
Airborne sound insulation	EN ISO 140-4	DnT,w + Ctr (dB)	48
Thermal conductivity	ISO8301	W/mK	0.04
Dynamic stiffness	EN29052-1 ISO9052-1	MN/m <sup>2</sup>	70
Ageing resistance	SP0414 ISO1798	years	50
Water absorption (after 24 hours)	DIN53428	volume %	0.5

### Impact Sound Test Results

TEST METHOD	UNITS	VALUE
EN ISO 140-7: 1998	L'nT,w (dB)	52

\* Criteria to pass test is less than 60 dB



**SRL** Sound Research  
Laboratories Limited

Sound Research  
Laboratories Limited  
Holbrook House, Little Waldingfield  
Sudbury, Suffolk CO10 0TH  
Test Report No. C/07/5L/3922/R03

### Impact Sound Insulation

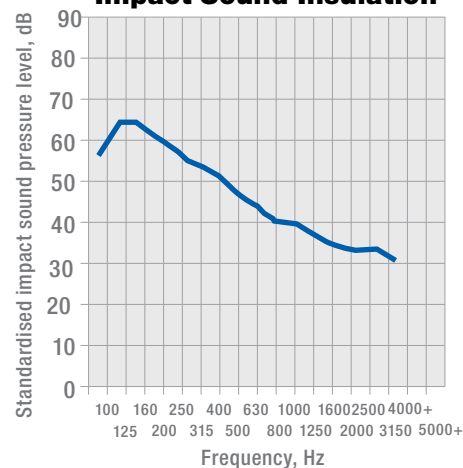

## Sealed Air

Specialty Materials  
Telford Way  
Kettering NN16 8UN  
United Kingdom  
+44 1536 315700 Fax: +44 1536 410576  
[www.sealedair-emea.com](http://www.sealedair-emea.com)

Corporate offices: Sealed Air Corporation,  
200 Riverfront Boulevard, Elmwood Park, NJ 07407, USA  
[www.sealedair.com](http://www.sealedair.com)

© Reg. U.S. Pat. & TM Off. © Sealed Air Corporation (US) 2008. All rights reserved.